



# Insulated Structures

*Efficiency At Work*

## 800 SERIES UPRIGHT WITH DOORS – SELF CONTAINED



Standard Specifications	
• 4 or 5 LED Lit Stainless Steel Shelves	• 2 x Probes (Air Off & Defrost)
• Canopy LED	• Standard Coil
• Glass Patch Ends	• Aluminium Ticket Rails
• Shaded Pole Fan	• Electronic Displays
• Valves (Brass Thermostatic)	

Optional Specifications
• LED Meatlamp: FRT ML2-24V (Meat Application)
• Available With Gravity Drain (To Plumbing System)
• Available with Condensate Pump

*Leaders in world class innovation for bespoke end to end energy efficient refrigeration solutions*



**Insulated Structures**  
*Efficiency At Work*



# Insulated Structures

Efficiency At Work

## 800 SERIES UPRIGHT WITH DOORS – SELF CONTAINED

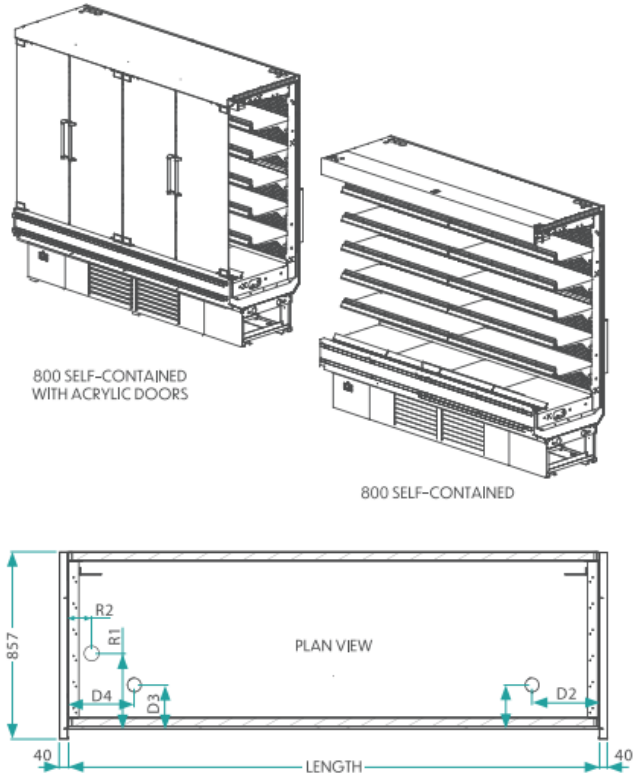
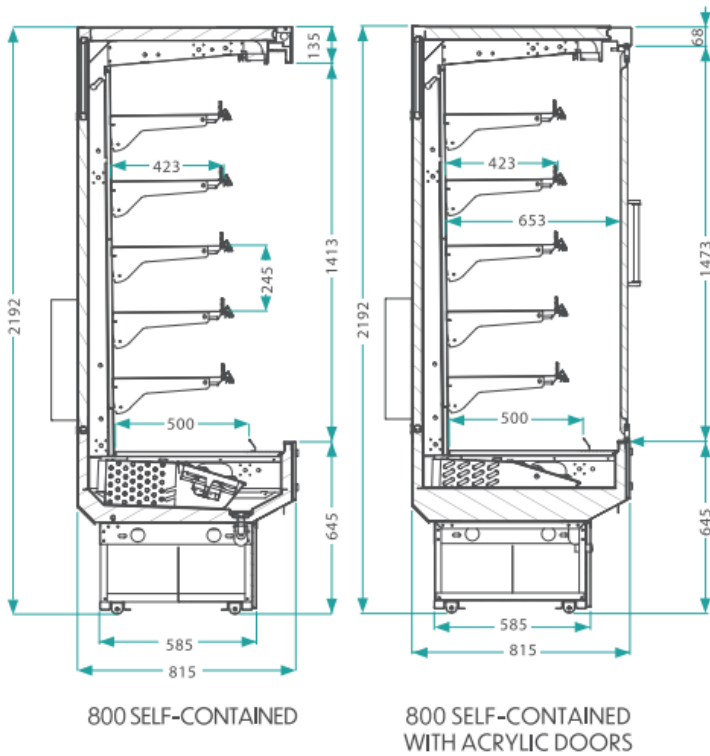

Physical Properties		
Size	Length (m)	TDA (m <sup>2</sup> )
4ft	1.22	1.81
6ft	1.83	2.71
8ft	2.44	3.61

Electronic Specifications					
Condensing Unit	Heaters (Boil-Off Pan)	Evaporator Fans Fan Blade+Motor	Lighting Shelf LED	Cond. Removal Pump	Amps Max Valve
HQHD-23KAR-1150W	1500W	2xØ200-28°/36W (SPM)	6x4ft = 72W	6x4ft = 72W	16A
HQHD-30KAR-1400W	1500W	3xØ200-28°/36W (SPM)	6x6ft = 115W	12x3ft = 120W	18A
HQHD-36KAR-1550W	1500W	4xØ200-28°/36W (SPM)	12x4ft = 144W	12x4ft = 144W	20A

Refrigeration Requirements			
Product	Refrigeration	Evaporator Temp	Defrost Cycle
Dairy	390W/ft	-6°C	OFF CYCLE
Meat	405W/ft	-8°C	OFF CYCLE

Drain & Refrigeration points					
D1	D2	D3	D4	R1	R2
200mm	610mm	-	-	350mm	90mm
200mm	915mm	-	-	350mm	90mm
200mm	300mm	200mm	300mm	350mm	90mm

Leaders in world class innovation for bespoke end to end energy efficient refrigeration solutions

